

Crescent Lane, SW4
Guide Price: £1,000,000 - £1,200,000



WILFORDS
LONDON



Crescent Lane, SW4

£1,000,000 - £1,200,000

1289 sq ft / 119.8 sq m

3 Bedrooms

3 Bathrooms

1 Reception Room

Kitchen

Share of Freehold

A well proportioned three bedroom converted flat arranged over the first and second floors in a magnificent Victorian terrace, measuring 1,289 sq. ft, offering accommodation more commonly associated with a house. The façade is in impeccable condition after recent stonework and pointing restoration. The share of freehold is on the market with no onward chain.

There is on street permit parking, and this section of Crescent Lane is generally residential traffic only. It is very well placed for the cafés, restaurants and upmarket shops of Abbeville Village and Clapham Old Town. Clapham Common offers open green space close by, and the property is only a short walk from the many main bus routes and Clapham Common Underground.



Approximate Area = 119.8 sq m / 1289 sq ft
Including Limited Use Area / Eaves (13.3 sq m / 143 sq ft)

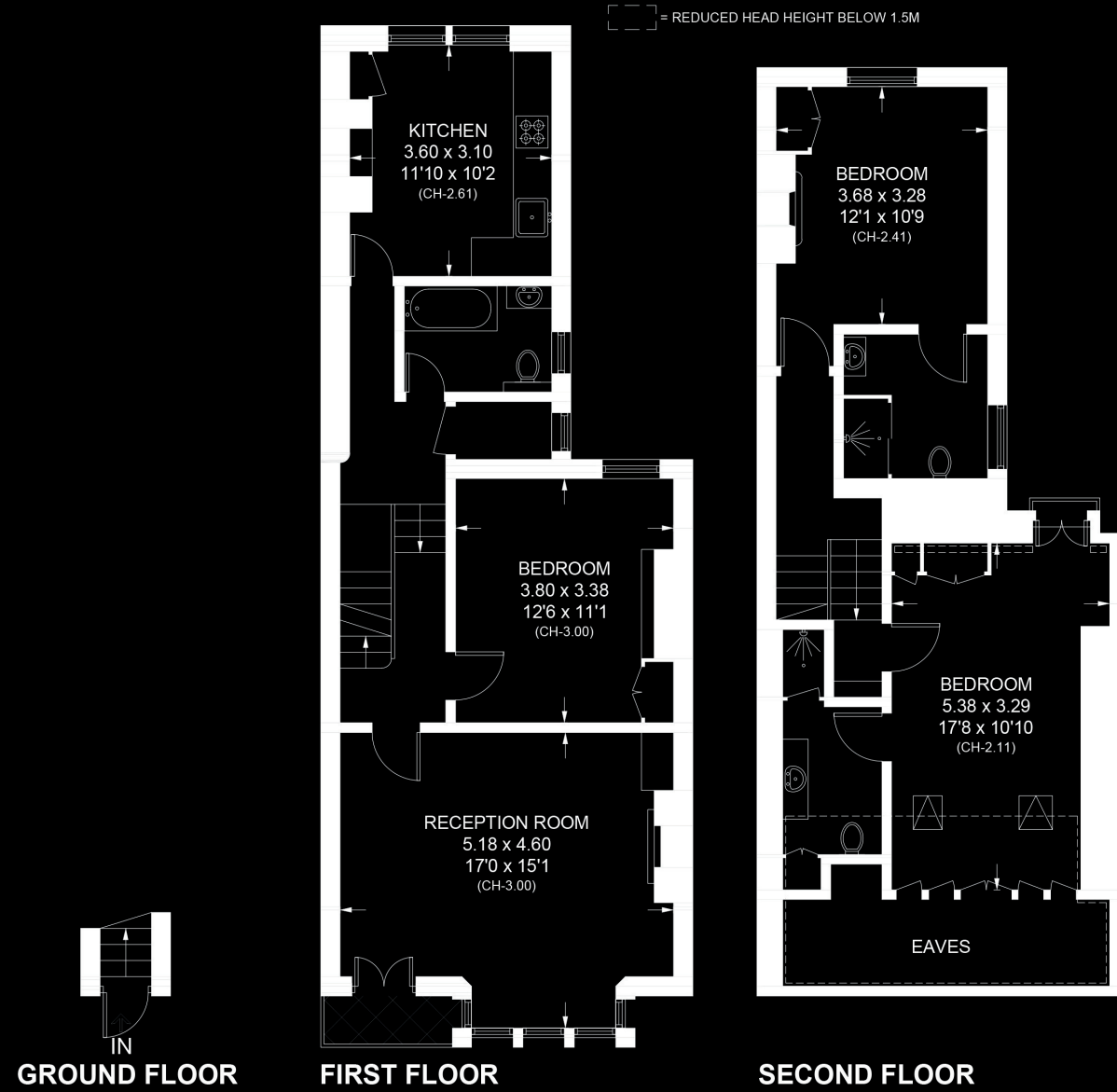

CRESCENT LANE, SW4

In accordance with the Property Mis-Description Act 1991, the following details have been prepared in good faith, and are not intended to constitute part of an offer or contract. Any information contained herein (whether in the text, plans or photographs) is given in good faith but should not be relied upon as being a statement of representation of fact. Nothing in these Particulars shall be deemed to be a statement that the property is in good condition or otherwise nor that any services or facilities are in good working order. Any measurements of distances referred to herein are approximate only.

This plan is for layout guidance only. Not drawn to scale unless stated. Windows and door openings are approximate. Whilst every care is taken in preparation of this plan, please check all dimensions, shapes and compass bearings before making any decisions reliant upon them.



42 Abbeville Rd, SW4 9NG
020 7361 0410
wilfords.com