

WINSHAM GROVE, BETWEEN THE COMMONS, SW11
GUIDE PRICE: £850,000 - £900,000



WILFORDS
LONDON

186 Northcote Rd.
London SW11 6RE
020 7361 0410

info@wilfords.com

www.wilfords.com



WINSHAM GROVE, BETWEEN THE COMMONS, SW11
GUIDE PRICE: £850,000 - £900,000

947 SQ FT / 88 SQ M
2 BEDROOMS | 1 BATHROOM | 1 RECEPTION | SHARE OF FREEHOLD

Designed by Found Associates, this beautifully appointed two-bedroom ground floor garden flat is beautifully presented throughout. The apartment has a spacious open plan reception/dining/kitchen area which opens out into a bright 21-foot private south facing garden. There is a contemporary bathroom with Hansgrohe chrome fittings. The spacious storage cellar benefits from bespoke built in Lema wardrobes and is home to a utility area.

The principal bedroom is located at the front of the apartment with a large bay window and bespoke Lema wardrobes to create an abundance of storage. The bedrooms are divided by the family bathroom and the second bedroom has a bespoke double wardrobe and a casement window beneath which is a partially frosted glass wall to allow in more natural light. Oversized engineered doors accentuate the ceiling height the bedrooms and bathroom. Winsham Grove is one of the most desirable roads Between the Commons and is ideally located only moments away from the wide and open spaces of Clapham Common and the shops, bars and restaurants of the fashionable Northcote Road. Clapham South (Northern Line) is the closest Underground station and Clapham Junction is not too far away.

LEAD ARCHITECT: FOUND ASSOCIATES KITCHEN, BATHROOM & WARDROBE DESIGN: DESIGN SPACE LONDON

**SCAN TO VIEW
THIS PROPERTY**



Approximate Gross Internal Area
79 sq m / 850 sq ft
Basement = 9 sq m / 97 sq ft
Total = 88 sq m / 947 sq ft

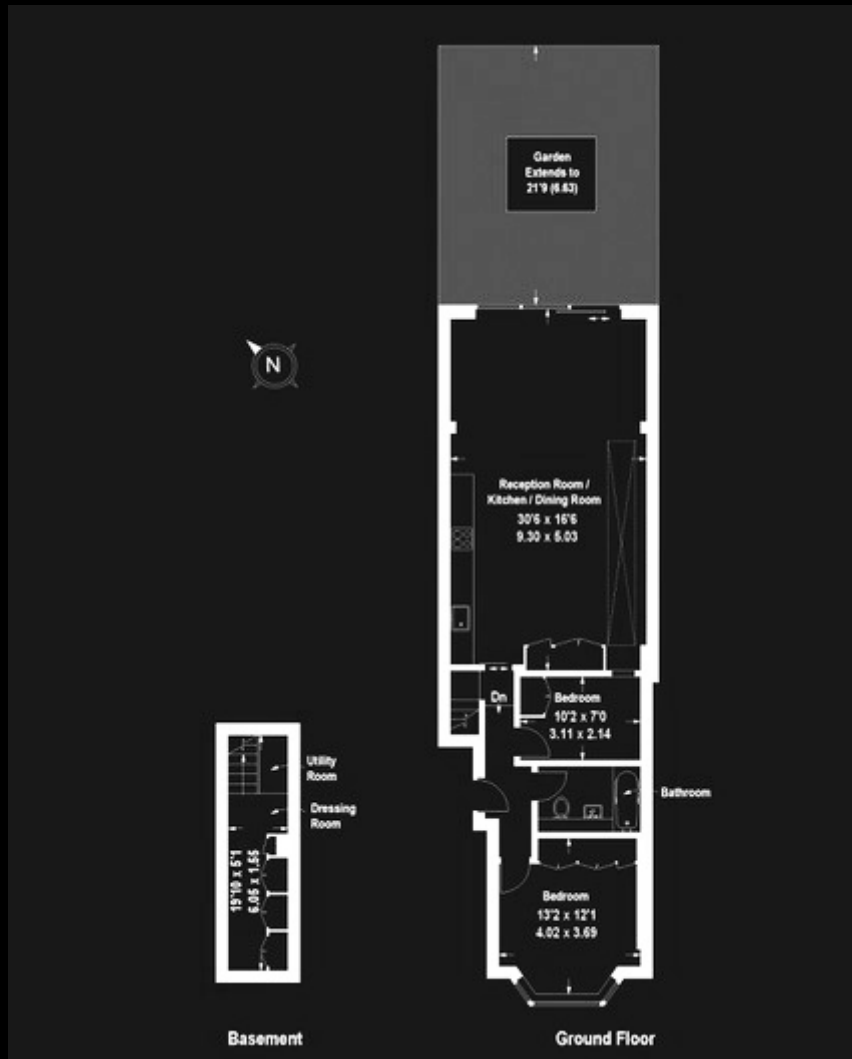

WINSHAM GROVE, BETWEEN THE COMMONS, SW11

Floor plan for identification purposes only - not to scale.

Misrepresentation Act 1967. This brochure and the descriptions and measurements herein do not constitute representation, and whilst every effort has been made to ensure accuracy, this cannot be guaranteed.

WILFORDS
LONDON

186 Northcote Rd,
London SW11 6RE
020 7361 0410

info@wilfords.com

www.wilfords.com