

SALCOTT ROAD, BETWEEN THE COMMONS, SW11
GUIDE PRICE: £2,000,000 - £2,250,000



WILFORDS
LONDON

186 Northcote Rd,
London SW11 6RE
020 7361 0410

info@wilfords.com

www.wilfords.com



SALCOTT ROAD, BETWEEN THE COMMONS, SW11

GUIDE PRICE: £2,000,000 - £2,250,000

2,209 SQ FT / 205 SQ M

4 BEDROOMS | 4 BATHROOMS | 4 RECEPTIONS | FREEHOLD

Charming and extensively refurbished Victorian terraced house arranged over four floors and extending to over 2,200 sq ft. This property features a lovely garden, perfect for outdoor relaxation. Located in a sought-after area Between the Commons.

Offering a versatile layout, the property comprises a stylish kitchen breakfast with Shaker units and a useful breakfast bar, a dining room and a bright reception room at the back opening to the lovely private garden, which offers a peaceful retreat ideal for al fresco dining or outdoor relaxation.

Upstairs there is an impressive principal suite which boasts a luxurious en suite bathroom with a walk-in wardrobe, offering a private and stylish sanctuary reception rooms. Three further bedrooms and bathrooms. A thoughtfully converted basement provides valuable additional living space and includes a family/media room, utility area, and guest WC. Period features throughout lend charm and character, while thoughtful updates ensure modern comfort.

Perfectly positioned within easy reach of both Clapham Common and Wandsworth Common, as well as excellent local schools, amenities, and transport links, this exceptional home promises a highly desirable lifestyle in one of South West London's most popular neighbourhoods.

SCAN TO VIEW
THIS PROPERTY



Approximate Area = 205.2 sq m / 2209 sq ft
(Including Limited Use Area / Eaves 10.5 sq m / 113 sq ft)

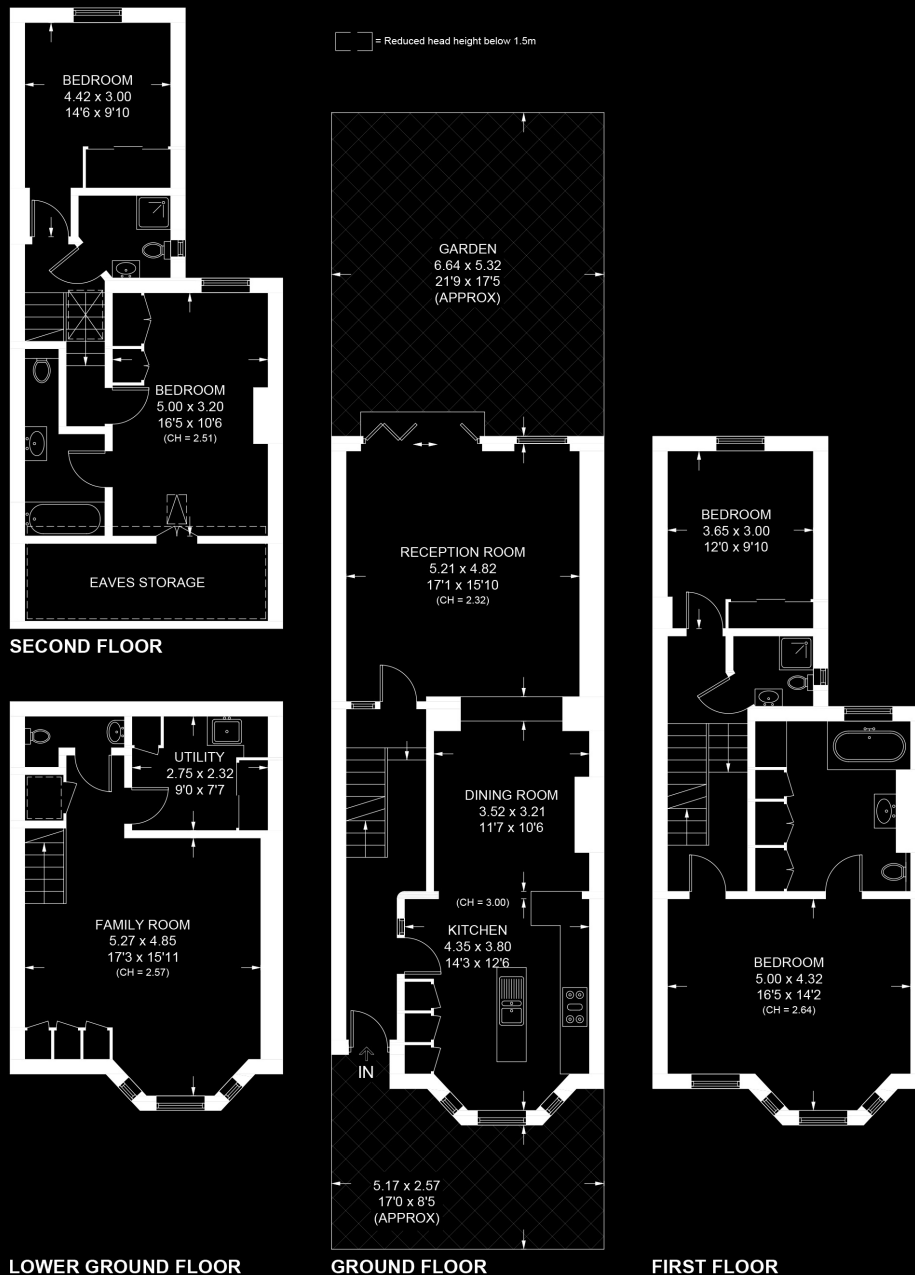

SALCOTT ROAD, BETWEEN THE COMMONS, SW11

Floor plan for identification purposes only - not to scale.

Misrepresentation Act 1967. This brochure and the descriptions and measurements herein do not constitute representation, and whilst every effort has been made to ensure accuracy, this cannot be guaranteed.

WILFORDS
LONDON

186 Northcote Rd,
London SW11 6RE
020 7361 0410

info@wilfords.com

www.wilfords.com