

JOHN ARCHER WAY, WANDSWORTH COMMON, SW18  
GUIDE PRICE: £500,000 - £550,000



WILFORDS  
LONDON

186 Northcote Rd,  
London SW11 6RE  
020 7361 0410

[info@wilfords.com](mailto:info@wilfords.com)

[www.wilfords.com](http://www.wilfords.com)





**JOHN ARCHER WAY, WANDSWORTH COMMON, SW18**  
GUIDE PRICE: £500,000 - £550,000

632 SQ FT / 59 SQ M  
2 BEDROOMS | 2 BATHROOMS | 1 RECEPTION | LEASEHOLD

Nestled in the sought-after John Archer Way development, this stylish and well-proportioned two-bedroom, two-bathroom flat offers 632 sq ft of contemporary living space. The bright and airy reception room is complemented by a separate modern kitchen, ideal for both entertaining and everyday living.

The spacious primary bedroom features built-in storage and a sleek en-suite shower room, while the second double bedroom is served by a well-appointed family bathroom.

Located moments from the green open spaces of Wandsworth Common and within easy reach of Clapham Junction and Wandsworth Town stations, this home offers the perfect balance of comfort, convenience, and connectivity.

Ideal for first-time buyers, young professionals, or investors alike.

**SCAN TO VIEW  
THIS PROPERTY**





Approximate Internal Area = 59 sq m / 632 sq ft

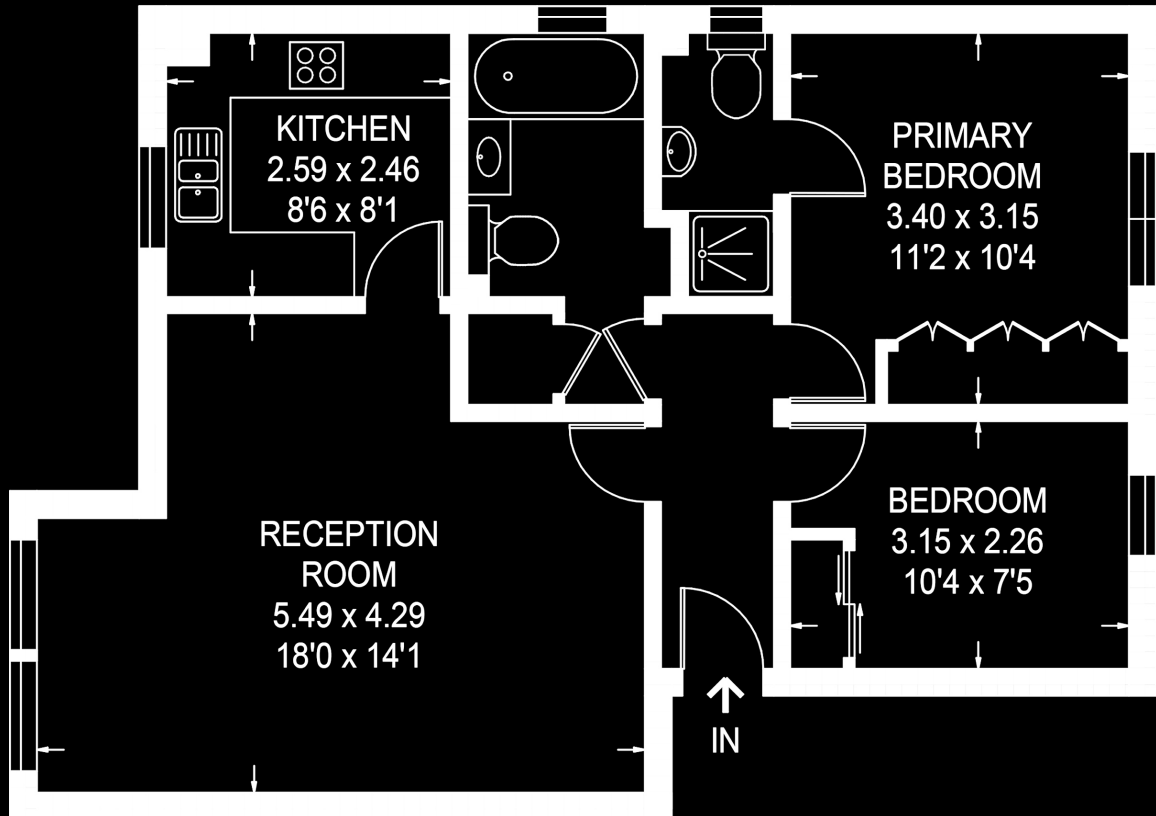

## JOHN ARCHER WAY, WANDSWORTH COMMON, SW18

Floor plan for identification purposes only - not to scale.

Misrepresentation Act 1967. This brochure and the descriptions and measurements herein do not constitute representation, and whilst every effort has been made to ensure accuracy, this cannot be guaranteed.

**WILFORDS**  
LONDON

186 Northcote Rd,  
London SW11 6RE  
020 7361 0410

info@wilfords.com

www.wilfords.com