

WINSHAM GROVE, BETWEEN THE COMMONS, SW11
GUIDE PRICE: £2,000,000 - £2,500,000



WILFORDS
LONDON

186 Northcote Rd,
London SW11 6RE
020 7361 0410

info@wilfords.com

www.wilfords.com



WINSHAM GROVE, BETWEEN THE COMMONS, SW11

GUIDE PRICE: £2,000,000 - £2,500,000

2,771 SQ FT / 257 SQ M

5 BEDROOMS | 5 BATHROOMS | 4 RECEPTIONS | FREEHOLD

An incredibly bright and spacious end of terrace Victorian family house which measures nearly 2,800 square feet (257 Sq. Mtrs) and is located just off Clapham Common Westside, in the most sought-after tree lined road, 'between the commons'.

The accommodation is arranged over four full floors and briefly comprises: entrance hall, cloakroom/W.C. three/four reception rooms, five double bedrooms served by five bathrooms (two en-suite) large kitchen/dining room, large utility room and extensive storage cupboards throughout the house. To the rear is a pretty walled garden which benefits from a useful side gate out to Adderley Grove. The property is flooded with natural light on all levels, with underfloor heating throughout the lower ground floor, which also benefits from 2.8 metre high ceilings.

Winsham Grove has always been highly regarded being easy walking distance to Clapham South underground station plus all the attractions on Northcote Road. Moreover, the area offers myriad primary and pre-school options both in the state and private sectors.

SCAN TO VIEW
THIS PROPERTY



Approximate Area = 257.4 sq m / 2771 sq ft
Including Limited Use Area / Eaves (4.5 sq m / 48 sq ft)

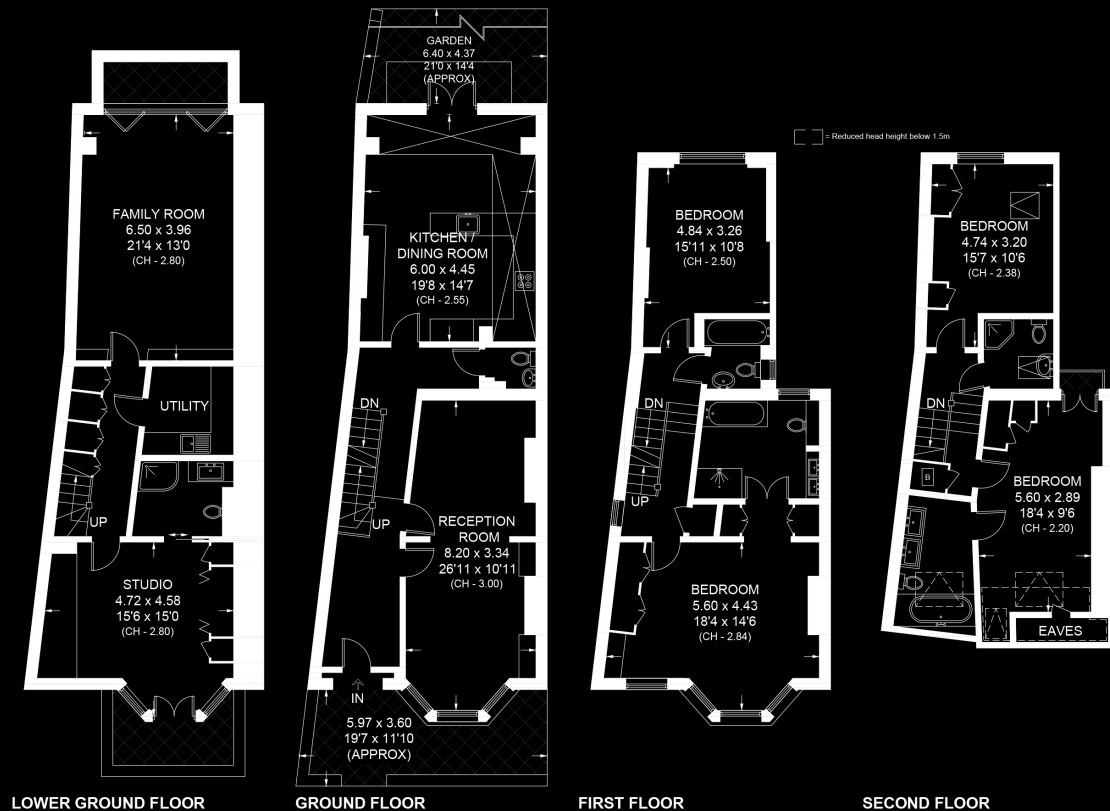

WINSHAM GROVE, BETWEEN THE COMMONS, SW11

Floor plan for identification purposes only - not to scale.

Misrepresentation Act 1967. This brochure and the descriptions and measurements herein do not constitute representation, and whilst every effort has been made to ensure accuracy, this cannot be guaranteed.

WILFORDS
LONDON

186 Northcote Rd,
London SW11 6RE
020 7361 0410

info@wilfords.com

www.wilfords.com