

LONSDALE ROAD, BARNES, SW13  
GUIDE PRICE: £4,500,000 - £5,000,000



WILFORDS  
LONDON

186 Northcote Rd,  
London SW11 6RE  
020 7361 0410

[info@wilfords.com](mailto:info@wilfords.com)

[www.wilfords.com](http://www.wilfords.com)





## LONSDALE ROAD, BARNES, SW13

GUIDE PRICE: £4,500,000 - £5,000,000

4,513 SQ FT / 419 SQ M

6 BEDROOMS | 5 BATHROOMS | 5 RECEPTIONS | FREEHOLD

An imposing stucco fronted Victorian villa, dating from circa 1860, which measures in excess of 4,500 square feet and yet offers scope to be further extended as well as representing something of a blank canvas for an incoming purchaser to remodel an already prestigious home into something extraordinary.

Set back from the road with a substantial gravel driveway for several cars plus an integral garage, this incredible home offers generously proportioned accommodation, arranged over four floors. This historic property, which retains some incredible original features, is also home to the last remaining Mulberry tree out of 101 trees planted circa 200 years ago, on land once owned by Lord Lonsdale.

The house is exceedingly conveniently positioned for the amenities of both Hammersmith Broadway and Barnes Village with its range of shops, art galleries, boutiques, the Olympic Studios cinema, restaurants and bars. As well as the well-known Barnes duck pond, common and the OSO Arts Centre.

For the commuter Barnes Station and Barnes Bridge Station offer a frequent service into Waterloo. There are also bus services serving Putney, and Richmond while Hammersmith is a mere 12-minute stroll away. All of which offer underground connections in and out of Town. Heathrow airport is easily accessible.

Families will appreciate the proximity to highly regarded state and independent schools, in the area include: St Paul's School, The Harrodian, The Swedish School and Istock Place School. For younger pupils, St Paul's Juniors, St Osmunds' (RC), Lowther Primary School and Barnes Primary School. While just across the River and therefore readily accessible schools include Ravenscourt Park Preparatory, Latymer, Godolphin and Latymer, and West London Free.

**SCAN TO VIEW  
THIS PROPERTY**





Approximate Area = 419.3 sq m / 4513 sq ft  
Including Limited Use Area (6.6 sq m / 71 sq ft)

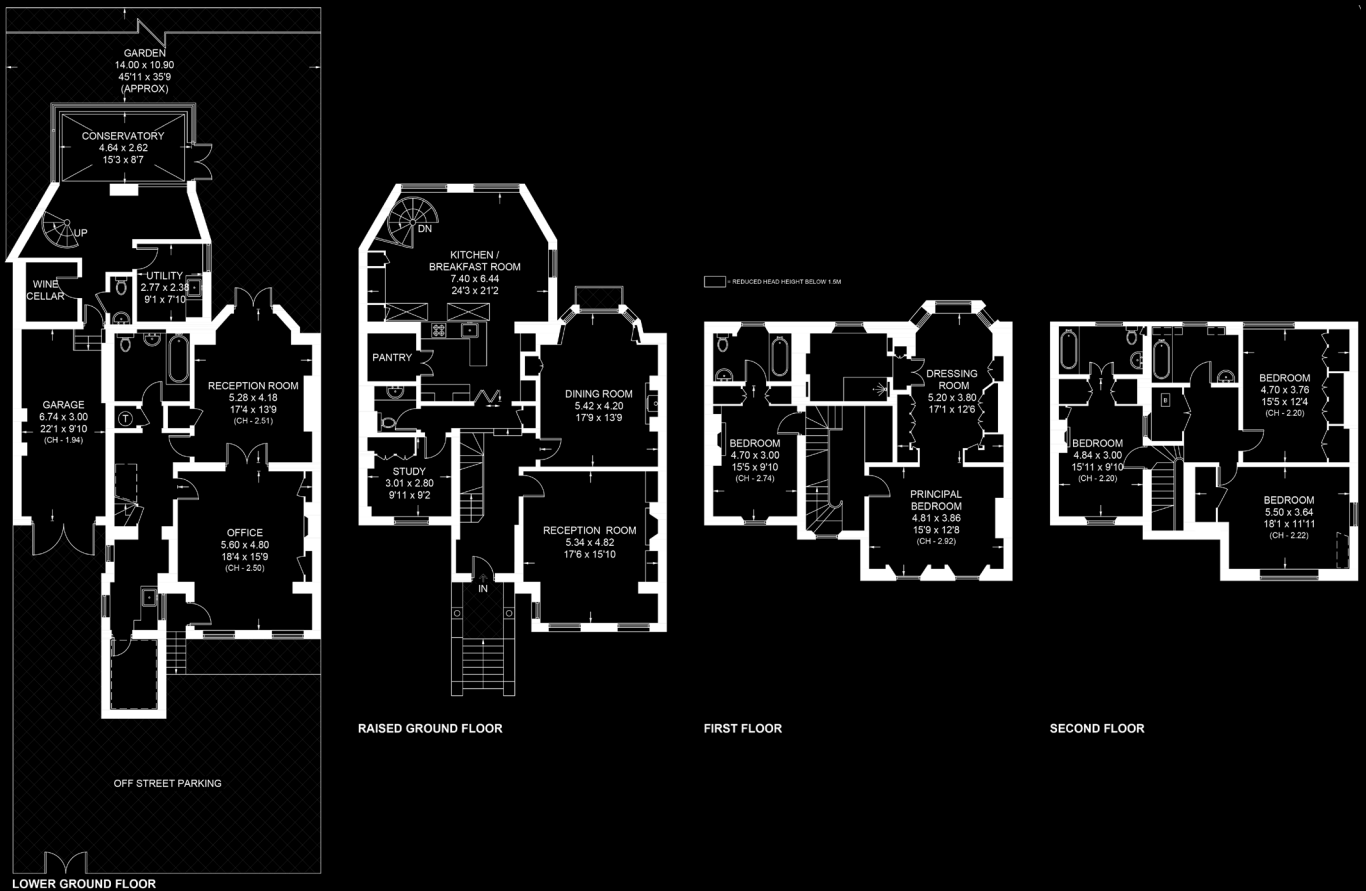

## LONSDALE ROAD, BARNES, SW13

Floor plan for identification purposes only - not to scale.

Misrepresentation Act 1967. This brochure and the descriptions and measurements herein do not constitute representation, and whilst every effort has been made to ensure accuracy, this cannot be guaranteed.

**WILFORDS**  
LONDON

186 Northcote Rd,  
London SW11 6RE  
020 7361 0410

info@wilfords.com

www.wilfords.com