

SHANDON ROAD, ABBEVILLE VILLAGE, SW4
GUIDE PRICE: £1,750,000 - £1,850,000



WILFORDS
LONDON

186 Northcote Rd,
London SW11 6RE
020 7361 0410

info@wilfords.com

www.wilfords.com



SHANDON ROAD, ABBEVILLE VILLAGE, SW4
GUIDE PRICE: £1,750,000 - £1,850,000

2,162 SQ FT / 201 SQ M
4 BEDROOMS | 3 BATHROOMS | 2 RECEPTION | FREEHOLD

A stylish and particularly attractive terrace Victorian family house situated in the heart of Abbeville Village.

Measuring 2,162 square feet, this well-maintained home retains many fine period features, while having been expertly extended and modernised throughout. The principal bedroom has an incredible mezzanine floor above with its luxury en-suite bathroom.

Arranged over three floors plus a basement cellar the well-balanced accommodation briefly comprises, four double bedrooms served by three bath/shower rooms, a wide double reception room and generous kitchen dining room. The rear garden is over 18' wide making it wider than many in the area.

Shandon Road is just off Abbeville Road that runs through the Abbeville Village and therefore is conveniently located for the independent shops, cafes and restaurants. Clapham South tube station is with easy walking distance, as are myriad nursery and primary schools in both the private and state sectors.

**SCAN TO VIEW
THIS PROPERTY**



Approximate Gross Internal Area = 201 sq m / 2,162 sq ft

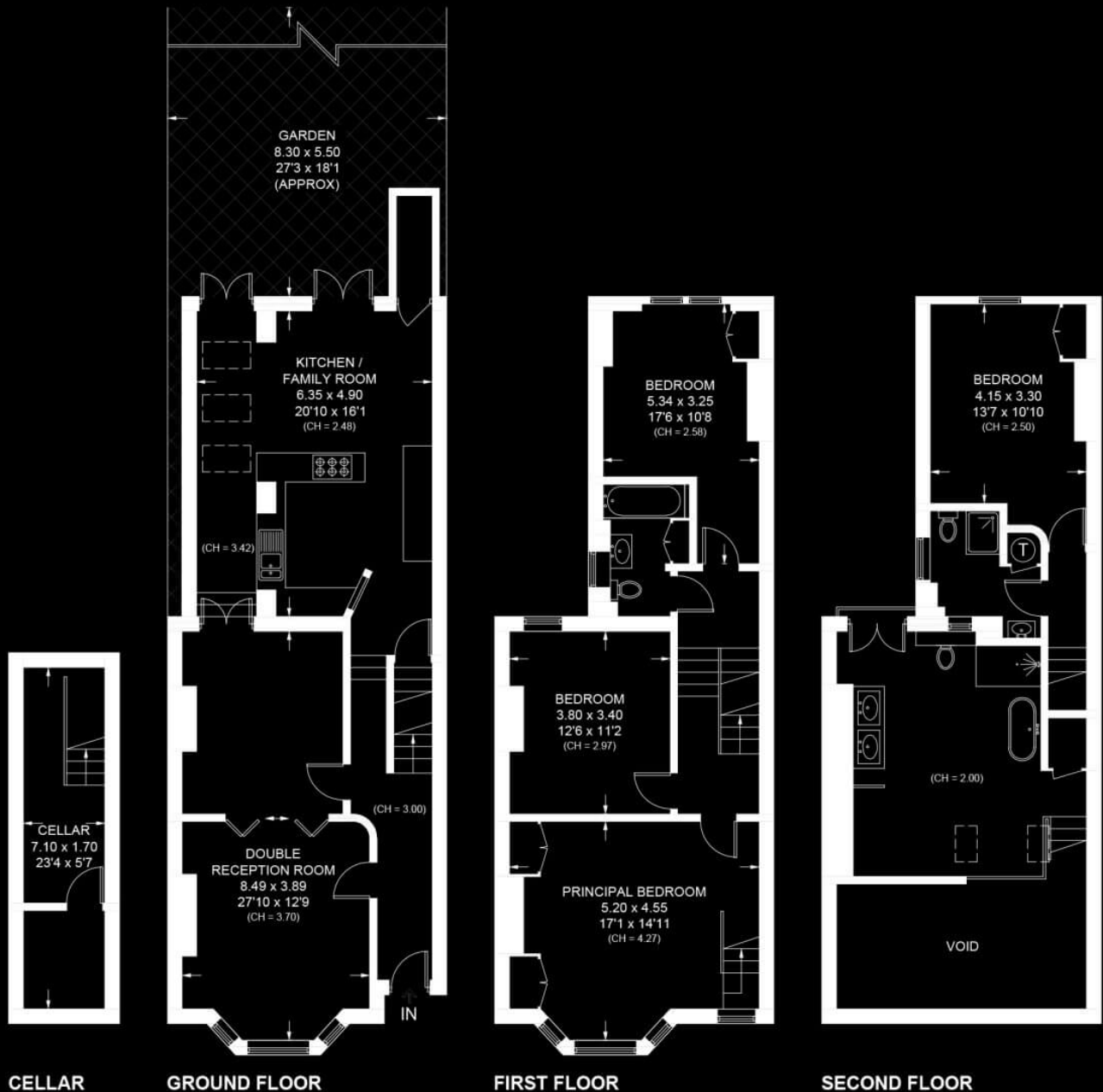

SHANDON ROAD, ABBEVILLE VILLAGE, SW4

Floor plan for identification purposes only - not to scale.

Misrepresentation Act 1967. This brochure and the descriptions and measurements herein do not constitute representation, and whilst every effort has been made to ensure accuracy, this cannot be guaranteed.

WILFORDS
LONDON

186 Northcote Rd,
London SW11 6RE
020 7361 0410

info@wilfords.com

www.wilfords.com